

- Notes:
1. Do not scale from this drawing. If in doubt refer to the project manager for clarification.
 2. All dimensions are shown in metres unless otherwise stated.
 3. Layout based on Ordnance Survey MasterMap, © Crown Copyright 2018. All rights reserved. Licence number 100022432.
 4. Exact length of kerb to be replaced should be confirmed on site by the contractor
 5. Kerb heights are to be retained as per existing and should tie in with accessible bus stops.

- Key:
- OS Mapping
 - Splay kerbs to be replaced with bullnose kerb
 - Transition kerb splay kerbs to bullnose kerb
 - Existing road markings
 - Proposed double yellow lines
 - Proposed unrestricted parking bay
 - Existing bus stop

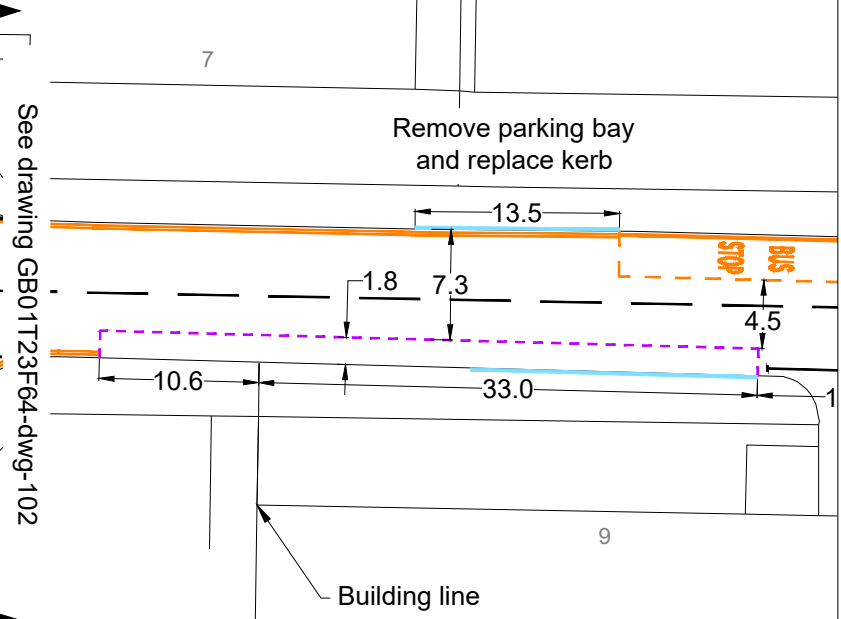

P3	01/09/25	Updates from LB DAD comments on Traffic Order Plans	DH	DH	DM
P2	03/04/25	Updates from LB B4D comments	OE	DH	DM
P1	18/02/25	Building numbers added	MIE	ARM	DM
P0	16/01/25	Initial Design	MIE	ARM	DM
Rev	Date	Revision details	Drawn	Check	Approv

© This drawing is the property of SYSTRA Limited and the information can only be reproduced with their prior permission.

SYSTRA
1 Carey Lane
London
EC2V 8AE
T 020 3714 4400
E uk_london@systra.com
W www.systra.co.uk



Thames Road Parking Review

**Phase 1: Thames Road
Setting Out
Sheet 1 of 6**

Date	16/01/2025	Drawn	MIE	Checked	ARM	Approved	DM
Original dtp size	A1	Scale	1:500	Drawing Status	Preliminary	Rev.	P3
Drawing Number	GB01T23F64-dwg-101						

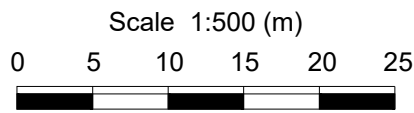

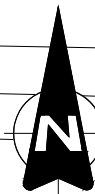
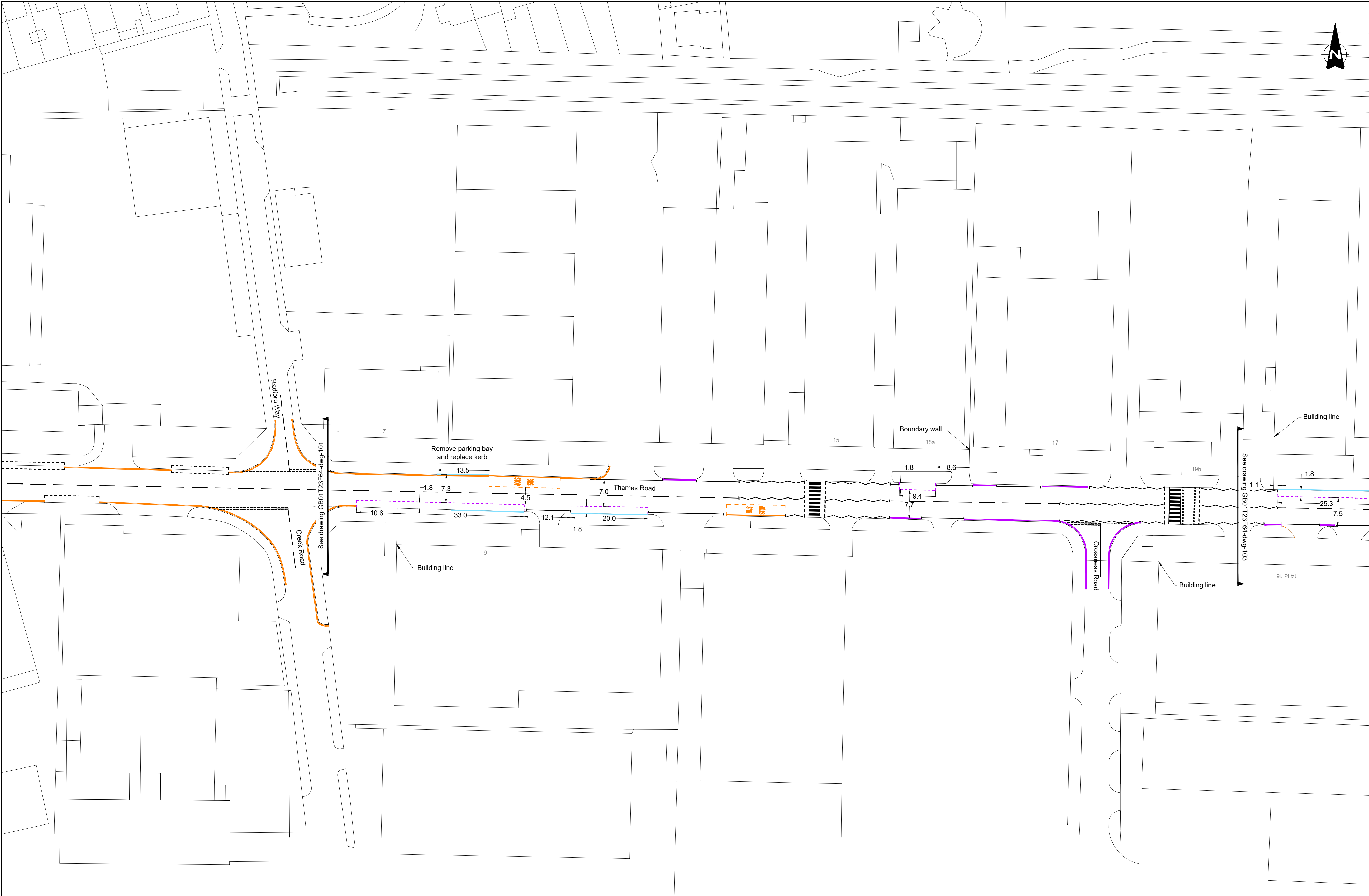

- Notes:
1. Do not scale from this drawing. If in doubt refer to the project manager for clarification.
 2. All dimensions are shown in metres unless otherwise stated.
 3. Layout based on Ordnance Survey MasterMap, © Crown Copyright 2018. All rights reserved. Licence number 100022432.
 4. Exact length of kerb to be replaced should be confirmed on site by the contractor
 5. Kerb heights are to be retained as per existing and should tie in with accessible bus stops.

- Key:
- OS Mapping
 - Splay kerbs to be replaced with bullnose kerb
 - Transition kerb splay kerbs to bullnose kerb
 - Existing road markings
 - Proposed double yellow lines
 - Proposed unrestricted parking bay
 - Existing bus stop

P3	01/09/25	Updates from LB DAD comments on Traffic Order Plans	DH	DH	DM
P2	03/04/25	Updates from LB B4D comments	OE	DH	DM
P1	18/02/25	Building numbers added	MIE	ARM	DM
P0	16/01/25	Initial Design	MIE	ARM	DM
Rev	Date	Revision details	Drawn	Check	Approv

© This drawing is the property of SYSTRA Limited and the information can only be reproduced with their prior permission



1 Carey Lane
London
EC2V 8AE

T 020 3714 4400
E uk_london@systra.com
W www.systra.co.uk

Client



Project

Thames Road Parking Review

Title

Phase 1: Thames Road
Setting Out
Sheet 2 of 6

Date	16/01/2025	Drawn	MIE	Checked	ARM	Approved	DM
Original dtp size	A1	Scale	1:500	Drawing Status	Preliminary	Rev.	P3
Drawing Number	GB01T23F64-dwg-102						

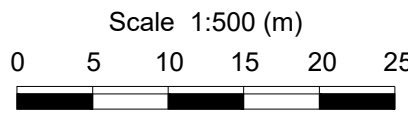

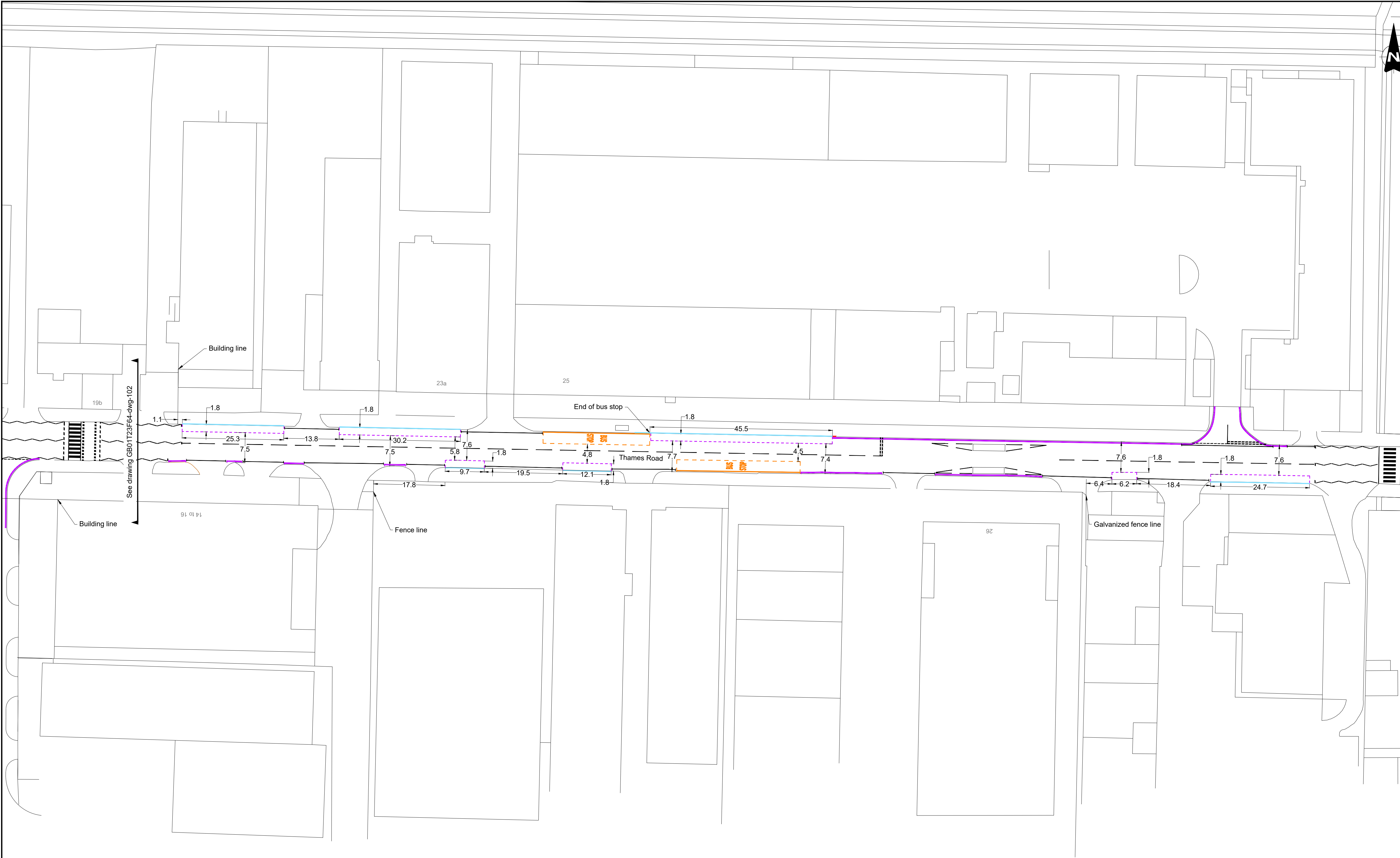

- Notes:
- 1. Do not scale from this drawing. If in doubt refer to the project manager for clarification.
 - 2. All dimensions are shown in metres unless otherwise stated.
 - 3. Layout based on Ordnance Survey MasterMap, © Crown Copyright 2018. All rights reserved. Licence number 100022432.
 - 4. Exact length of kerb to be replaced should be confirmed on site by the contractor
 - 5. Kerb heights are to be retained as per existing and should tie in with accessible bus stops.

- Key:
- OS Mapping
 - Splay kerbs to be replaced with bullnose kerb
 - Transition kerb splay kerbs to bullnose kerb
 - Existing road markings
 - Proposed double yellow lines
 - Proposed unrestricted parking bay
 - Existing bus stop

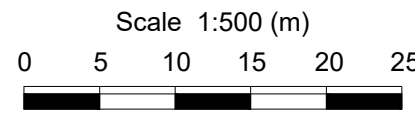

P3	01/09/25	Updates from LB DAD comments on Traffic Order Plans	DH	DH	DM
P2	03/04/25	Updates from LB B&D comments	OE	DH	DM
P1	18/02/25	Building numbers added	MIE	ARM	DM
P0	16/01/25	Initial Design	MIE	ARM	DM
Rev	Date	Revision details	Drawn	Check	Approv

© This drawing is the property of SYSTRA Limited and the information can only be reproduced with their prior permission.

1 Carey Lane
London
EC2V 8AE
T 020 3714 4400
E uk_london@systra.com
W www.systra.co.uk

Client

Project

Thames Road Parking Review

Title

Phase 1: Thames Road
Setting Out
Sheet 3 of 6

Date	16/01/2025	Drawn	MIE	Checked	ARM	Approved	DM
Original dtp size	A1	Scale	1:500	Drawing Status	Preliminary	Rev.	P3
Drawing Number	GB01T23F64-dwg-103						

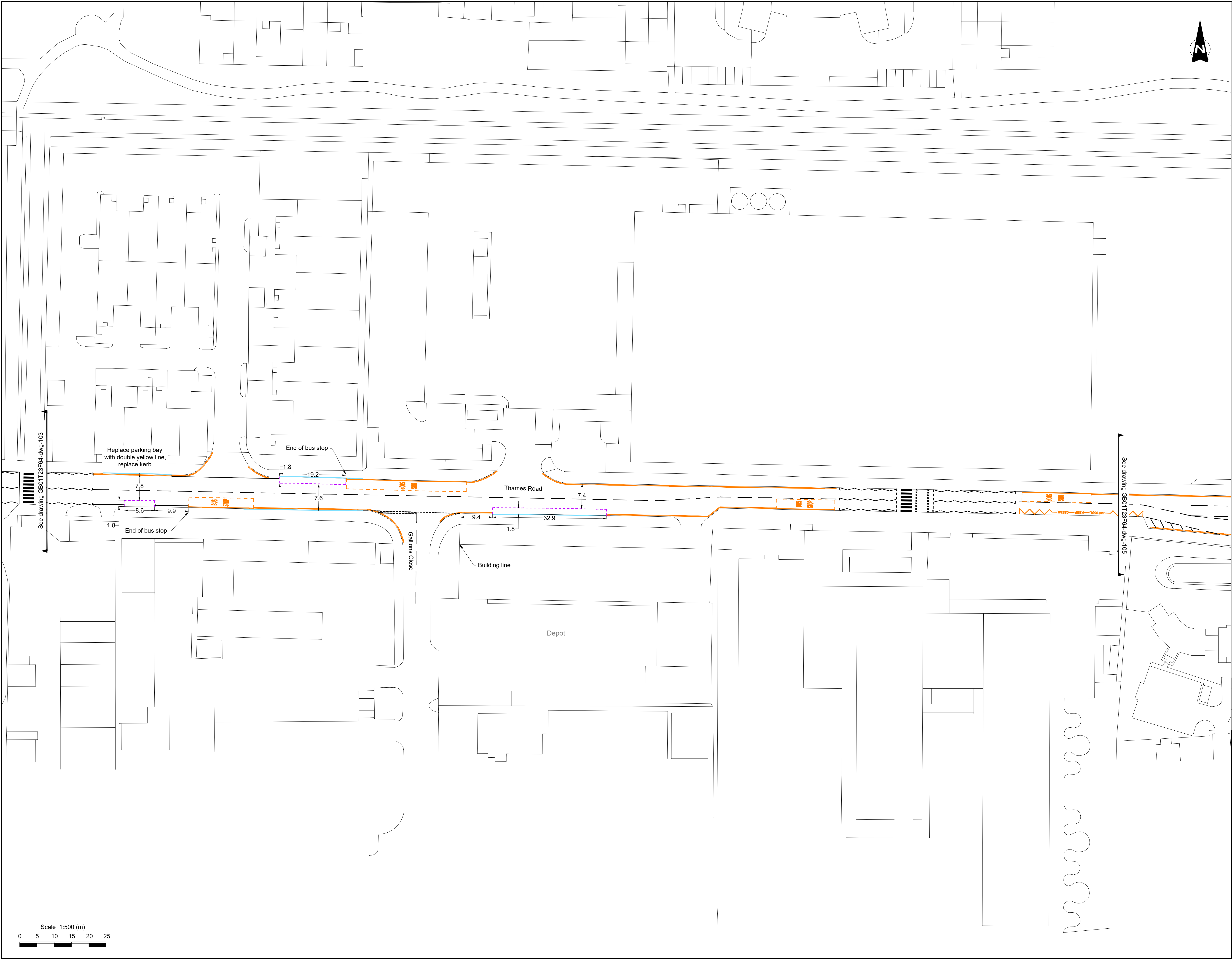

- Notes:
1. Do not scale from this drawing. If in doubt refer to the project manager for clarification.
 2. All dimensions are shown in metres unless otherwise stated.
 3. Layout based on Ordnance Survey MasterMap, © Crown Copyright 2018. All rights reserved. Licence number 100022432.
 4. Exact length of kerb to be replaced should be confirmed on site by the contractor
 5. Kerb heights are to be retained as per existing and should tie in with accessible bus stops.

- Key:
- OS Mapping
 - Splay kerbs to be replaced with bullnose kerb
 - Transition kerb splay kerbs to bullnose kerb
 - Existing road markings
 - Proposed double yellow lines
 - Proposed unrestricted parking bay
 - Existing bus stop

See drawing GB01T23F64-dwg-103

See drawing GB01T23F64-dwg-105

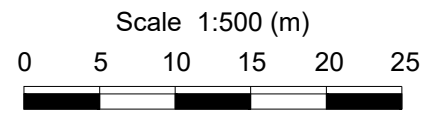

P3	01/09/25	Updates from LB DAD comments on Traffic Order Plans	DH	DH	DM
P2	03/04/25	Updates from LB B4D comments	OE	DH	DM
P1	18/02/25	Building numbers added	MIE	ARM	DM
P0	16/01/25	Initial Design	MIE	ARM	DM
Rev	Date	Revision details	Drawn	Check	Approv

© This drawing is the property of SYSTRA Limited and the information can only be reproduced with their prior permission.

1 Carey Lane
London
EC2V 8AE

T 020 3714 4400
E uk_london@systra.com
W www.systra.co.uk

Client

Project

Thames Road Parking Review

Title

Phase 1: Thames Road
Setting Out
Sheet 4 of 6

Date	16/01/2025	Drawn	MIE	Checked	ARM	Approved	DM
Original dtp size	A1	Scale	1:500	Drawing Status	Preliminary	Rev.	P3
Drawing Number	GB01T23F64-dwg-104						

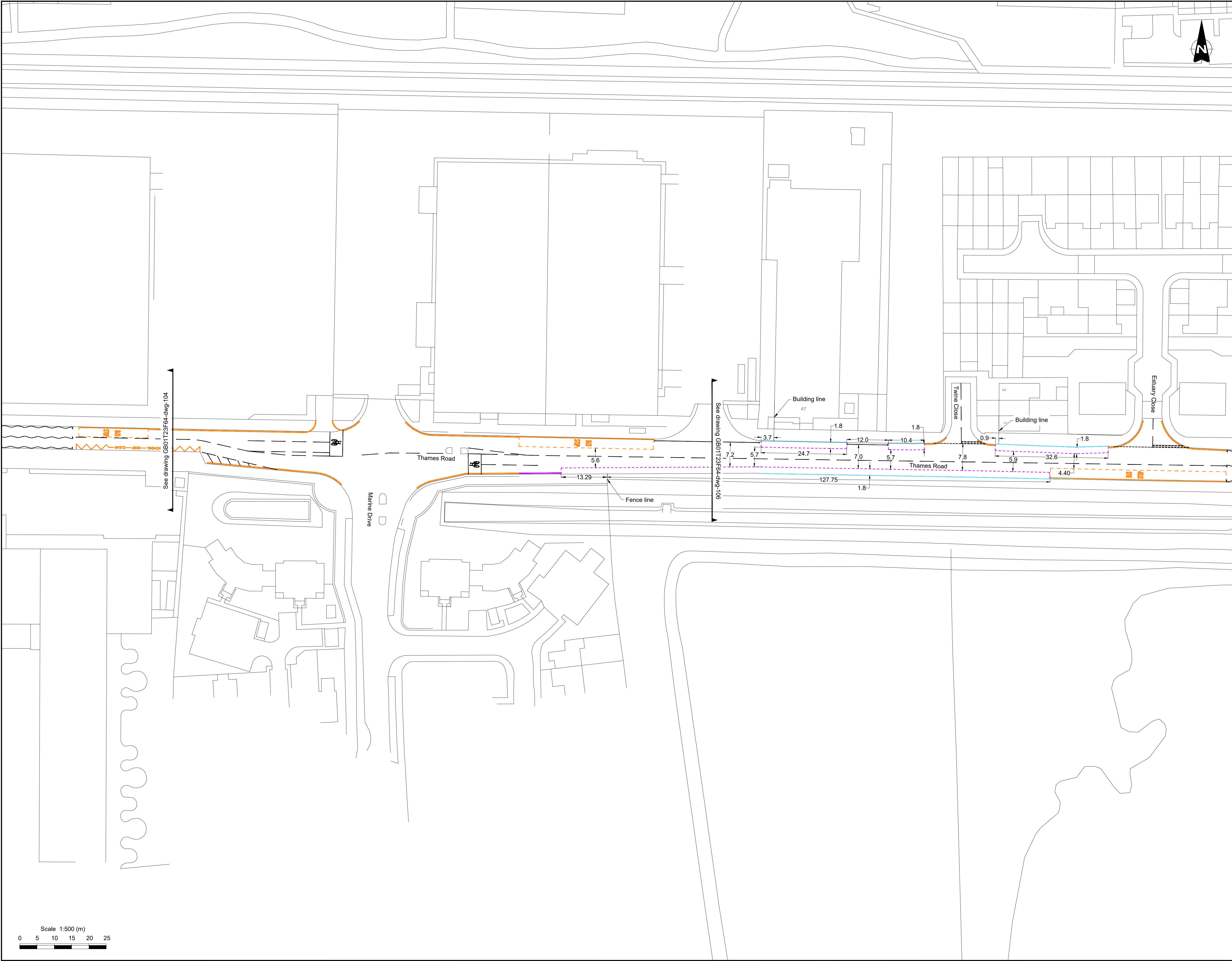

- Notes:
1. Do not scale from this drawing. If in doubt refer to the project manager for clarification.
 2. All dimensions are shown in metres unless otherwise stated.
 3. Layout based on Ordnance Survey MasterMap, © Crown Copyright 2018. All rights reserved. Licence number 100022432.
 4. Exact length of kerb to be replaced should be confirmed on site by the contractor
 5. Kerb heights are to be retained as per existing and should tie in with accessible bus stops.

- Key:
- OS Mapping
 - Splay kerbs to be replaced with bullnose kerb
 - Transition kerb splay kerbs to bullnose kerb
 - Existing road markings
 - Proposed double yellow lines
 - Proposed unrestricted parking bay
 - Existing bus stop

P3	01/06/25	Updates from LB DAD comments on Traffic Order Plans	DH	DH	DM
P2	03/04/25	Updates from LB B4D comments	OE	DH	DM
P1	18/02/25	Building numbers added	MIE	ARM	DM
P0	16/01/25	Initial Design	MIE	ARM	DM
Rev	Date	Revision details	Drawn	Check	Approv

© This drawing is the property of SYSTRA Limited and the information can only be reproduced with their prior permission.



1 Carey Lane
London
EC2V 8AE

T 020 3714 4400
E uk_london@systra.com
W www.systra.co.uk

Client



Project

Thames Road Parking Review

Title

Phase 1: Thames Road
Setting Out
Sheet 5 of 6

Date	16/01/2025	Drawn	MIE	Checked	ARM	Approved	DM
Original dwg size	A1	Scale	1:500	Drawing Status	Preliminary	Rev.	P3
Drawing Number	GB01T23F64-dwg-105						

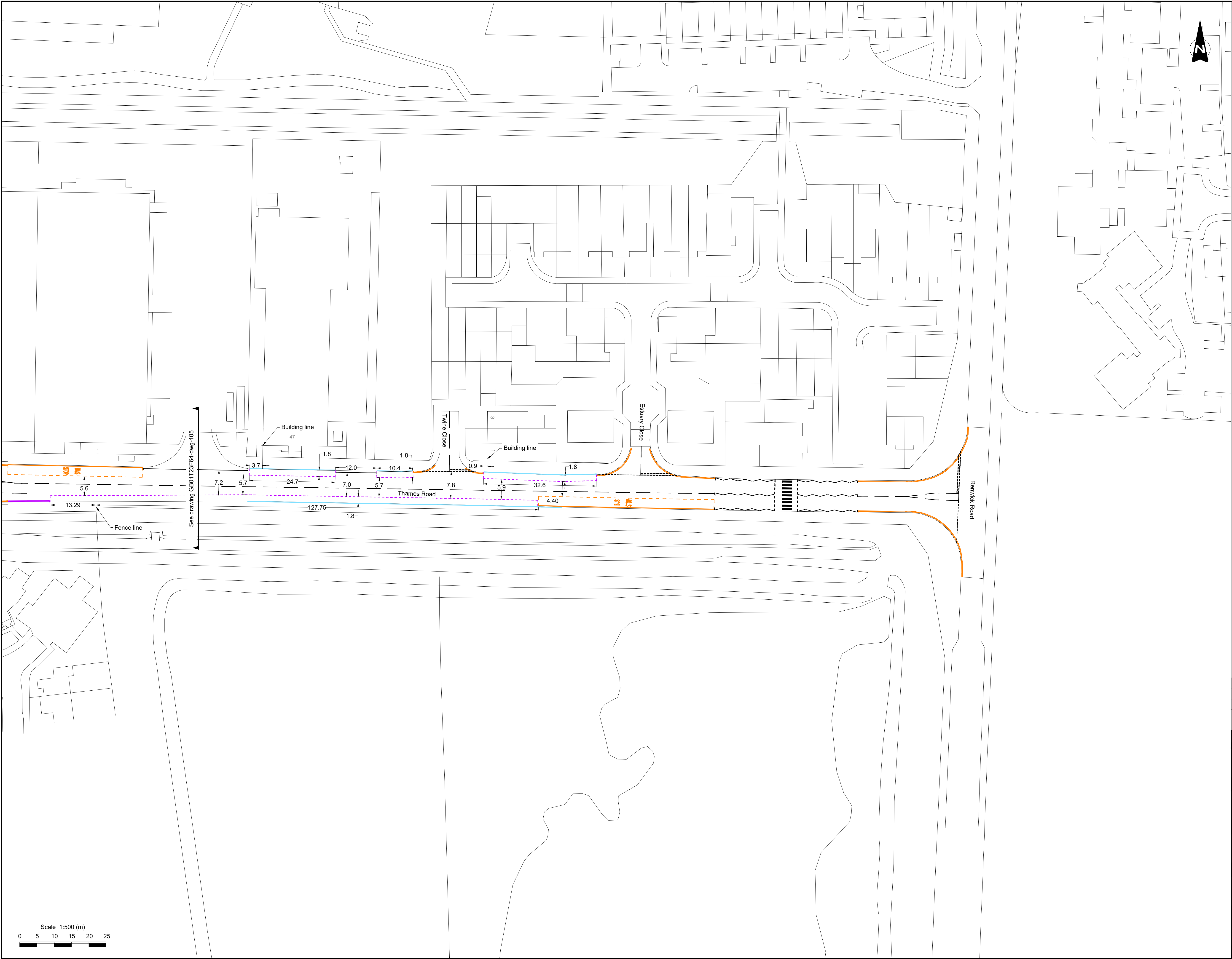

- Notes:
1. Do not scale from this drawing. If in doubt refer to the project manager for clarification.
 2. All dimensions are shown in metres unless otherwise stated.
 3. Layout based on Ordnance Survey MasterMap, © Crown Copyright 2018. All rights reserved. Licence number 100022432.
 4. Exact length of kerb to be replaced should be confirmed on site by the contractor
 5. Kerb heights are to be retained as per existing and should tie in with accessible bus stops.

Key:

- OS Mapping
- Splay kerbs to be replaced with bullnose kerb
- Transition kerb splay kerbs to bullnose kerb
- Existing road markings
- Proposed double yellow lines
- Proposed unrestricted parking bay
- Existing bus stop

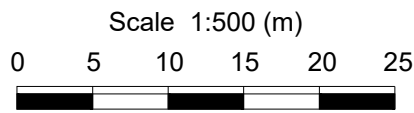

P3	01/06/25	Updates from LB DAD comments on Traffic Order Plans	DH	DH	DM
P2	03/04/25	Updates from LB B&D comments	OE	DH	DM
P1	18/02/25	Building numbers added	MIE	ARM	DM
P0	16/01/25	Initial Design	MIE	ARM	DM
Rev	Date	Revision details	Drawn	Check	Approv

© This drawing is the property of SYSTRA Limited and the information can only be reproduced with their prior permission.

SYSTRA

1 Carey Lane
London
EC2V 8AE

T 020 3714 4400
E uk_london@systra.com
W www.systra.co.uk

Client

BeFirst

Project

Thames Road Parking Review

Title

**Phase 1: Thames Road
Setting Out
Sheet 6 of 6**

Date	16/01/2025	Drawn	MIE	Checked	ARM	Approved	DM
Original dtp size	A1	Scale	1:500	Drawing Status	Preliminary	Rev.	P3
Drawing Number	GB01T23F64-dwg-106						