

0	20/11/2023	ORIGINAL ISSUE		TA	DM	MA
Rev	Date	Description		Drm	Chk	App
This drawing has been specifically prepared to meet the requirements of the named client and may contain design and innovative features which differ from conventional design standards.						

PROJECT
CENTRE

www.marstonholdings.co.uk/projectcentre

Working in partnership				Barking & Dagenham	
Project					
LONGBRIDGE ROAD BUS PRIORITY DETAILED DESIGN					
Drawing Title					
GENERAL ARRANGEMENT SECTION 4 OVERVIEW PLAN					
Drawing Status					
FOR CONSTRUCTION					
Drawn	Designed	Date	Scale	Size	
TA	DM	NOV 2023	N. T. S.	A1	
Drawing No. 1000009040-5-S4-0100-00					Rev 0

SAFETY, HEALTH AND ENVIRONMENTAL INFORMATION

In addition to the hazards/risks normally associated with the type of work detailed on this drawing, note the following significant risks and information identified by the designer

▲ CONSTRUCTION
---- No significant hazards

▲ DEMOLITION
---- No significant hazards

▲ MAINTENANCE & OPERATION
---- No significant hazards

It is assumed that all works be carried out by a competent contractor working to an approved method statement.
Approved by: MA

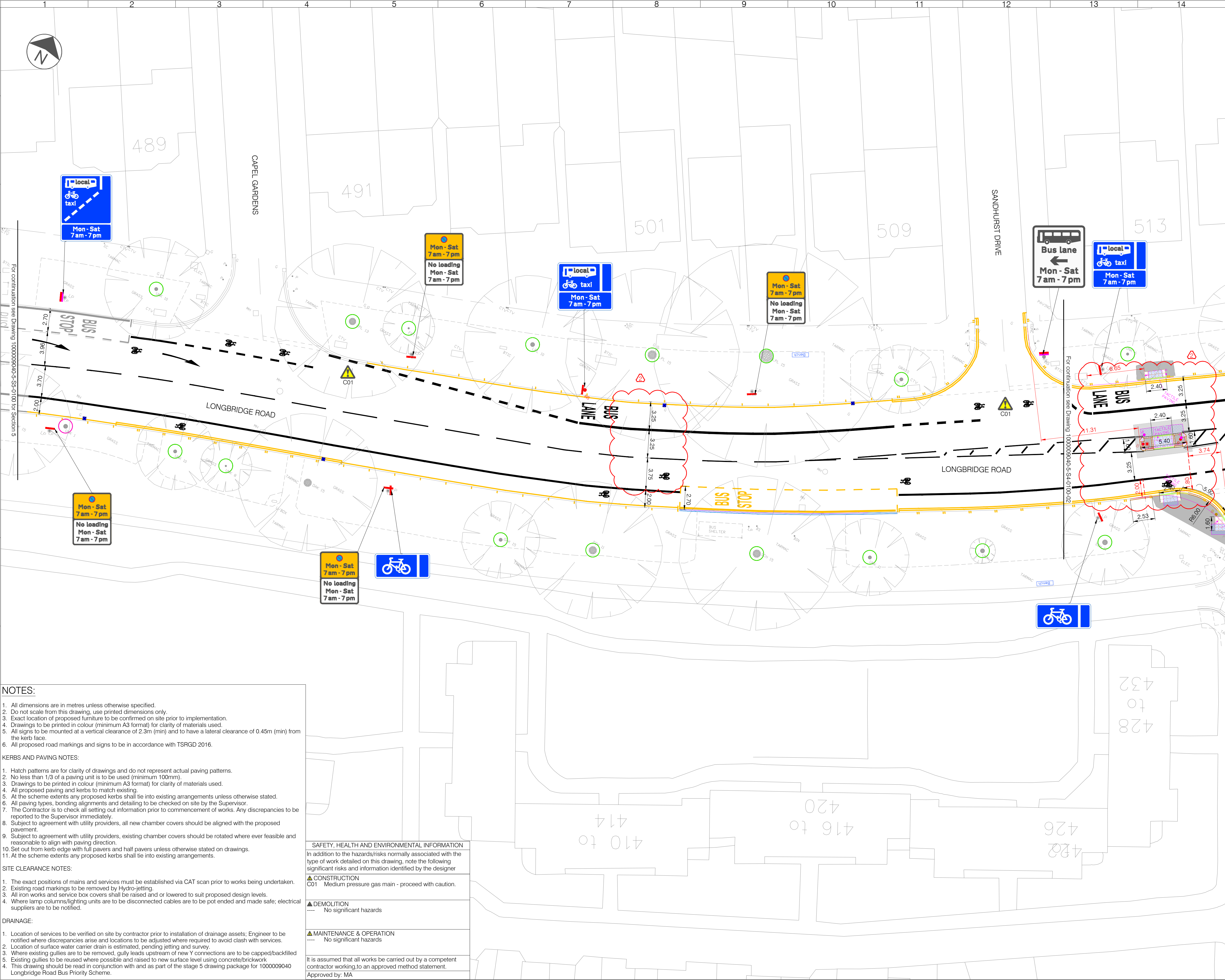

- NOTES:**
1. All dimensions are in metres unless otherwise specified.
 2. Do not scale from this drawing, use printed dimensions only.
 3. Exact location of proposed furniture to be confirmed on site prior to implementation.
 4. Drawings to be printed in colour (minimum A3 format) for clarity of materials used.
 5. All signs to be mounted at a vertical clearance of 2.3m (min) and to have a lateral clearance of 0.45m (min) from the kerb face.
 6. All proposed road markings and signs to be in accordance with TSRGD 2016.

- KERBS AND PAVING NOTES:**
1. Hatch patterns are for clarity of drawings and do not represent actual paving patterns.
 2. No less than 1/3 of a paving unit is to be used (minimum 100mm).
 3. Drawings to be printed in colour (minimum A3 format) for clarity of materials used.
 4. All proposed paving and kerbs to match existing.
 5. At the scheme extents any proposed kerbs shall tie into existing arrangements unless otherwise stated.
 6. All paving types, bonding alignments and detailing to be checked on site by the Supervisor.
 7. The Contractor is to check all setting out information prior to commencement of works. Any discrepancies to be reported to the Supervisor immediately.
 8. Subject to agreement with utility providers, all new chamber covers should be aligned with the proposed pavement.
 9. Subject to agreement with utility providers, existing chamber covers should be rotated where ever feasible and reasonable to align with paving direction.
 10. Set out from kerb edge with full pavers and half pavers unless otherwise stated on drawings.
 11. At the scheme extents any proposed kerbs shall tie into existing arrangements.

- SITE CLEARANCE NOTES:**
1. The exact positions of mains and services must be established via CAT scan prior to works being undertaken.
 2. Existing road markings to be removed by Hydro-jetting.
 3. All iron works and service box covers shall be raised and or lowered to suit proposed design levels.
 4. Where lamp columns/lighting units are to be disconnected cables are to be pot ended and made safe; electrical suppliers are to be notified.

- DRAINAGE:**
1. Location of services to be verified on site by contractor prior to installation of drainage assets; Engineer to be notified where discrepancies arise and locations to be adjusted where required to avoid clash with services.
 2. Location of surface water carrier drain is estimated, pending jetting and survey.
 3. Where existing gullies are to be removed, gully leads upstream of new Y connections are to be capped/backfilled
 5. Existing gullies to be reused where possible and raised to new surface level using concrete/brickwork
 4. This drawing should be read in conjunction with and as part of the stage 5 drawing package for 1000009040 Longbridge Road Bus Priority Scheme.

SAFETY, HEALTH AND ENVIRONMENTAL INFORMATION	
In addition to the hazards/risks normally associated with the type of work detailed on this drawing, note the following significant risks and information identified by the designer	
▲ CONSTRUCTION	
C01 Medium pressure gas main - proceed with caution.	
▲ DEMOLITION	
--- No significant hazards	
▲ MAINTENANCE & OPERATION	
--- No significant hazards	
It is assumed that all works be carried out by a competent contractor working to an approved method statement.	
Approved by: MA	

LEGEND	
	Install yellow road marking
	Thermoplastic screed with applied glass beads
	Install white road marking
	Thermoplastic screed with applied glass beads
	Install upstand kerb (80mm to 125mm upstand)
	Precast Concrete, silver grey
	Install upstand kerb by bus stops (125mm upstand)
	Precast Concrete, silver grey
	Install dropped kerb (0mm upstand)
	Precast Concrete, silver grey
	Install dropper/transition Kerb
	Precast Concrete, silver grey
	Install flushed kerb (0mm upstand)
	Precast Concrete, silver grey
	Install edging kerb
	Change of level
	Direction of surface water flow
	Install new posts
	Galvanised steel, straight sign posts
	Install new signs
	Install illuminated bollard on traffic islands
	Install wooden bollard
	Install new/relocated lamp column
	Existing post to be removed
	Existing sign to be removed
	Install built tactile paving
	400x400x65mm
	Existing gully to be retained
	Existing footway to be excavated and replaced by new asphalt construction:
	Surface course: 20mm AC6 Dense 100/150
	Binder course: 80mm thick AC20 dense bin 40/60
	Base: 150mm Recycled Thick Type 1
	Install asphalt (black top) on existing carriageway:
	Surface course: 40mm TSCS 10 65psv
	Install asphalt (black top) new/existing traffic island:
	Surface course: 35mm AC6 Dense 100/150
	Binder course: 80mm thick AC20 dense bin 40/60
	Base: 150mm Recycled Thick Type 1
	Colour: Deep Chrome Green
	Install cycle track on footway:
	Surface course: 6mm AC6 Dense 100/150
	Binder course: 80mm thick AC20 dense bin 40/60
	Base: 150mm Recycled Thick Type 1
	Colour: Deep Chrome Green
	Existing paving to be removed on footway
	Install low level planting
	Existing ironworks to be adjusted
	Bench
	Install new bench
	Install cycle lane defender with 'City Post' (TMP Solutions)
	2000mm x 235mm
	Existing tree to be pruned
	Existing tree not affected
	Setting out
	Setting out dimensions

Rev	Date	Description	Drm	Chk	App
2	24/01/2024	TRAFFIC LANE AND BUS LANE WIDTHS ADJUSTED TO 3.25M	TA	DM	MA
1	18/01/2024	SECTION REMOVED / AMENDED FOLLOWING CLIENT'S COMMENTS	TA	DM	MA
0	20/11/2023	ORIGINAL ISSUE	TA	DM	MA

PROJECT CENTRE

www.marstonholdings.co.uk/projectcentre

Client		Working in partnership <div> Barking & Dagenham</div>			
Project		LONGBRIDGE ROAD BUS PRIORITY DETAILED DESIGN			
Drawing Title		GENERAL ARRANGEMENT SECTION 4 SHEET 01 OF 03			
Drawing Status		FOR CONSTRUCTION			
Drawn	Designed	Date	Scale	Size	
TA	DM	NOV 2023	1:200	A1	
Drawing No.				Rev	
1000009040-5-S4-0100-01				2	

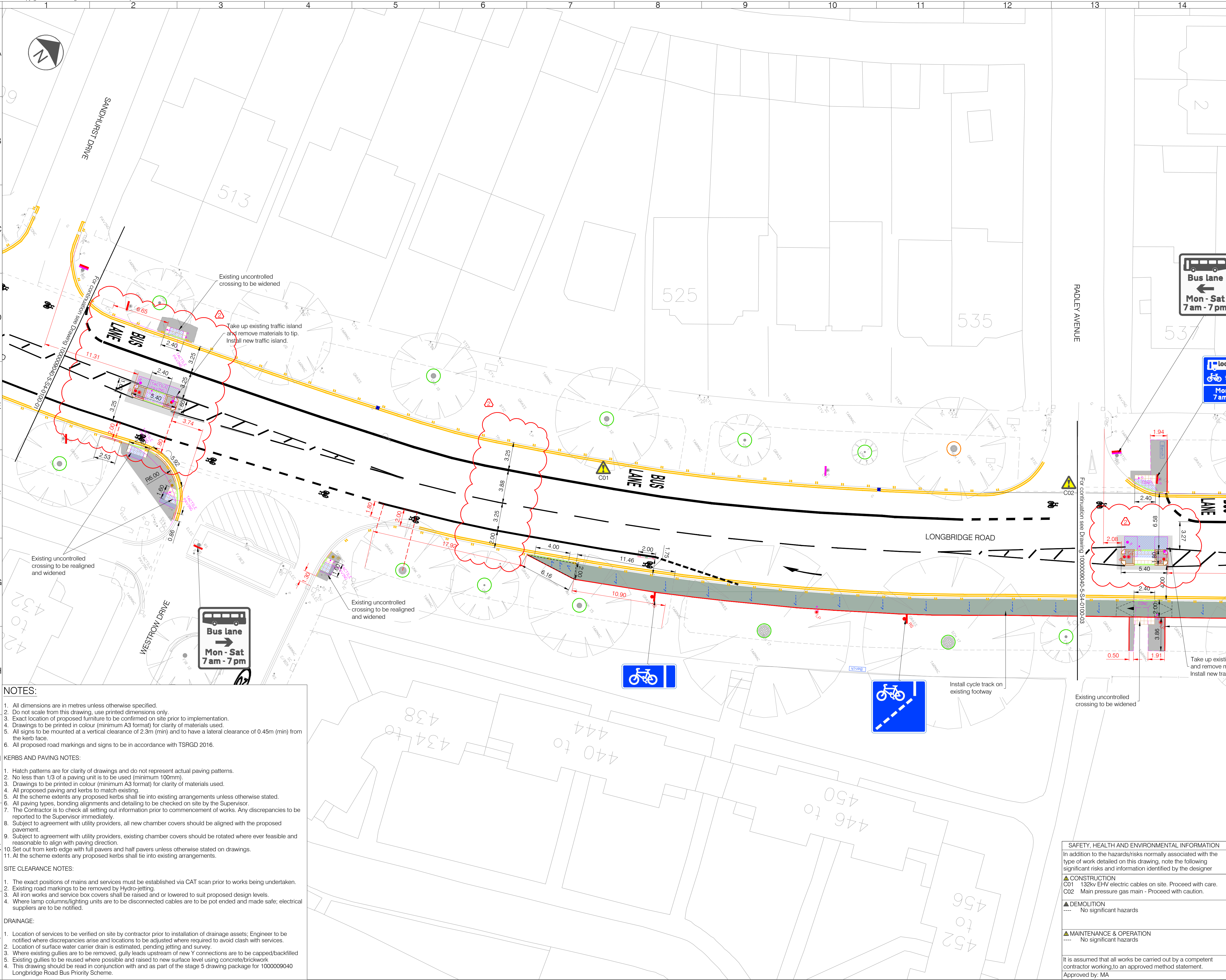

NOTES:

- All dimensions are in metres unless otherwise specified.
- Do not scale from this drawing, use printed dimensions only.
- Exact location of proposed furniture to be confirmed on site prior to implementation.
- Drawings to be printed in colour (minimum A3 format) for clarity of materials used.
- All signs to be mounted at a vertical clearance of 2.3m (min) and to have a lateral clearance of 0.45m (min) from the kerb face.
- All proposed road markings and signs to be in accordance with TSRGD 2016.

KERBS AND PAVING NOTES:

- Hatch patterns are for clarity of drawings and do not represent actual paving patterns.
- No less than 1/3 of a paving unit is to be used (minimum 100mm).
- Drawings to be printed in colour (minimum A3 format) for clarity of materials used.
- All proposed paving and kerbs to match existing.
- At the scheme extents any proposed kerbs shall tie into existing arrangements unless otherwise stated.
- All paving types, bonding alignments and detailing to be checked on site by the Supervisor.
- The Contractor is to check all setting out information prior to commencement of works. Any discrepancies to be reported to the Supervisor immediately.
- Subject to agreement with utility providers, all new chamber covers should be aligned with the proposed pavement.
- Subject to agreement with utility providers, existing chamber covers should be rotated where ever feasible and reasonable to align with paving direction.
- Set out from kerb edge with full pavers and half pavers unless otherwise stated on drawings.
- At the scheme extents any proposed kerbs shall tie into existing arrangements.

SITE CLEARANCE NOTES:

- The exact positions of mains and services must be established via CAT scan prior to works being undertaken.
- Existing road markings to be removed by Hydro-jetting.
- All iron works and service box covers shall be raised and or lowered to suit proposed design levels.
- Where lamp columns/lighting units are to be disconnected cables are to be pot ended and made safe; electrical suppliers are to be notified.

DRAINAGE:

- Location of services to be verified on site by contractor prior to installation of drainage assets; Engineer to be notified where discrepancies to be adjusted where required to avoid clash with services.
- Location of surface water carrier drain is estimated, pending jetting and survey.
- Where existing gullies are to be removed, gully leads upstream of new Y connections are to be capped/backfilled
- Existing gullies to be reused where possible and raised to new surface level using concrete/brickwork
- This drawing should be read in conjunction with and as part of the stage 5 drawing package for 1000009040 Longbridge Road Bus Priority Scheme.

- LEGEND**
- Install yellow road marking
 - Thermoplastic screed with applied glass beads
 - Install white road marking
 - Thermoplastic screed with applied glass beads
 - Install upstand kerb (80mm to 125mm upstand)
 - Precast Concrete, silver grey
 - Install upland kerb by bus stops (125mm upstand)
 - Precast Concrete, silver grey
 - Install dropped kerb (0mm upstand)
 - Precast Concrete, silver grey
 - Install dropper/transition Kerb
 - Precast Concrete, silver grey
 - Install flushed kerb (0mm upstand)
 - Precast Concrete, silver grey
 - Install edging kerb
 - Change of level
 - Direction of surface water flow
 - Install new posts
 - Galvanised steel, straight sign posts
 - Install new signs
 - Install illuminated bollard on traffic islands
 - Install wooden bollard
 - Install new/relocated lamp column
 - Existing post to be removed
 - Existing sign to be removed
 - Install buff tactile paving
 - 400x400x65mm
 - Existing gully to be retained
 - Existing footway to be excavated and replaced by new asphalt construction:
 - Surface course: 20mm AC6 Dense 100/150
 - Binder course: 80mm thick AC20 dense bin 40/60
 - Base: 150mm Recycled Thick Type 1
 - Install asphalt (black top) on existing carriageway:
 - Surface course: 40mm TSCS 10 65psv
 - Install asphalt (black top) new/existing traffic island:
 - Surface course: 35mm AC6 Dense 100/150
 - Binder course: 80mm thick AC20 dense bin 40/60
 - Base: 100mm Recycled Thick Type 1
 - Install cycle track on footway:
 - Surface course: 6mm AC6 Dense 100/150
 - Binder course: 80mm thick AC20 dense bin 40/60
 - Base: 150mm Recycled Thick Type 1
 - Colour: Deep Chrome Green
 - Existing paving to be removed on footway
 - Install low level planting
 - Existing ironworks to be adjusted
 - Bench
 - Install new bench
 - Install cycle lane defender with 'City Post' (TMP Solutions)
 - 2000mm x 235mm
 - Existing tree to be pruned
 - Existing tree not affected
 - Setting out
 - Setting out dimensions

Rev	Date	Description	Drm	Chk	App
2	24/01/2024	TRAFFIC LANE AND BUS LANE WIDTHS ADJUSTED TO 3.25M	TA	DM	MA
1	18/01/2024	SECTION REMOVED / AMENDED FOLLOWING CLIENT'S COMMENTS	TA	DM	MA
0	20/11/2023	ORIGINAL ISSUE	TA	DM	MA

PROJECT CENTRE

www.marstonholdings.co.uk/projectcentre

Client

Working in partnership
BeFirst **Barking & Dagenham**

Project

Longbridge Road
BUS PRIORITY
DETAILED DESIGN

Drawing Title

GENERAL ARRANGEMENT
SECTION 4
SHEET 02 OF 03

Drawing Status

FOR CONSTRUCTION

Drawn	Designed	Date	Scale	Size
TA	DM	NOV 2023	1:200	A1

Drawing No.

1000009040-5-S4-0100-02

Rev

2

SAFETY, HEALTH AND ENVIRONMENTAL INFORMATION

In addition to the hazards/risks normally associated with the type of work detailed on this drawing, note the following significant risks and information identified by the designer

▲ **CONSTRUCTION**
C01 132kv EHV electric cables on site. Proceed with care.
C02 Main pressure gas main - Proceed with caution.

▲ **DEMOLITION**
---- No significant hazards

▲ **MAINTENANCE & OPERATION**
---- No significant hazards

It is assumed that all works be carried out by a competent contractor working to an approved method statement.
Approved by: MA

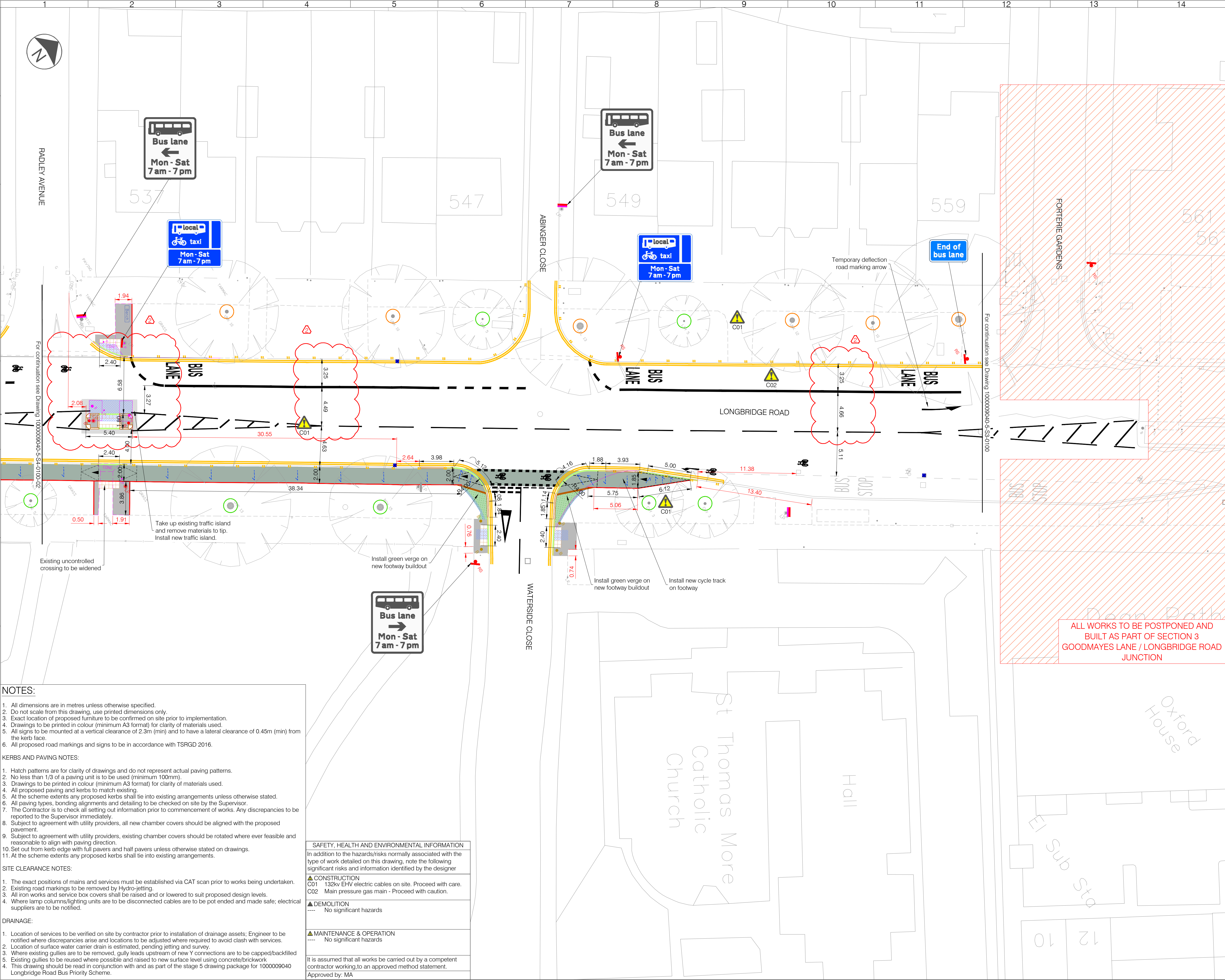

- NOTES:**
1. All dimensions are in metres unless otherwise specified.
 2. Do not scale from this drawing, use printed dimensions only.
 3. Exact location of proposed furniture to be confirmed on site prior to implementation.
 4. Drawings to be printed in colour (minimum A3 format) for clarity of materials used.
 5. All signs to be mounted at a vertical clearance of 2.3m (min) and to have a lateral clearance of 0.45m (min) from the kerb face.
 6. All proposed road markings and signs to be in accordance with TSRGD 2016.

- KERBS AND PAVING NOTES:**
1. Hatch patterns are for clarity of drawings and do not represent actual paving patterns.
 2. No less than 1/3 of a paving unit is to be used (minimum 100mm).
 3. Drawings to be printed in colour (minimum A3 format) for clarity of materials used.
 4. All proposed paving and kerbs to match existing.
 5. At the scheme extents any proposed kerbs shall tie into existing arrangements unless otherwise stated.
 6. All paving types, bonding alignments and detailing to be checked on site by the Supervisor.
 7. The Contractor is to check all setting out information prior to commencement of works. Any discrepancies to be reported to the Supervisor immediately.
 8. Subject to agreement with utility providers, all new chamber covers should be aligned with the proposed pavement.
 9. Subject to agreement with utility providers, existing chamber covers should be aligned where ever feasible and reasonable to align with paving direction.
 10. Set out from kerb edge with full pavers and half pavers unless otherwise stated on drawings.
 11. At the scheme extents any proposed kerbs shall tie into existing arrangements.

- SITE CLEARANCE NOTES:**
1. The exact positions of mains and services must be established via CAT scan prior to works being undertaken.
 2. Existing road markings to be removed by Hydro-jetting.
 3. All iron works and service box covers shall be raised and or lowered to suit proposed design levels.
 4. Where lamp columns/lighting units are to be disconnected cables are to be pot ended and made safe; electrical suppliers are to be notified.

- DRAINAGE:**
1. Location of services to be verified on site by contractor prior to installation of drainage assets; Engineer to be notified where discrepancies arise and locations to be adjusted where required to avoid clash with services.
 2. Location of surface water carrier drain is estimated, pending jetting and survey.
 3. Where existing gullies are to be removed, gully leads upstream of new Y connections are to be capped/backfilled
 5. Existing gullies to be reused where possible and raised to new surface level using concrete/brickwork
 4. This drawing should be read in conjunction with and as part of the stage 5 drawing package for 1000009040 Longbridge Road Bus Priority Scheme.

SAFETY, HEALTH AND ENVIRONMENTAL INFORMATION	
In addition to the hazards/risks normally associated with the type of work detailed on this drawing, note the following significant risks and information identified by the designer	
▲ CONSTRUCTION	
C01 132kv EHV electric cables on site. Proceed with care.	
C02 Main pressure gas main - Proceed with caution.	
▲ DEMOLITION	
---	No significant hazards
▲ MAINTENANCE & OPERATION	
---	No significant hazards
It is assumed that all works be carried out by a competent contractor working to an approved method statement.	
Approved by: MA	

LEGEND	
	Install yellow road marking
	Thermoplastic screed with applied glass beads
	Install white road marking
	Thermoplastic screed with applied glass beads
	Install upstand kerb (80mm to 125mm upstand)
	Precast Concrete, silver grey
	Install upstand kerb by bus stops (125mm upstand)
	Precast Concrete, silver grey
	Install dropped kerb (0mm upstand)
	Precast Concrete, silver grey
	Install dropper/transition Kerb
	Precast Concrete, silver grey
	Install flushed kerb (0mm upstand)
	Precast Concrete, silver grey
	Install edging kerb
	Change of level
	Direction of surface water flow
	Install new posts
	Galvanised steel, straight sign posts
	Install new signs
	Install illuminated bollard on traffic islands
	Install wooden bollard
	Install new/relocated lamp column
	Existing post to be removed
	Existing sign to be removed
	Install buff tactile paving
	400x400x65mm
	Existing gully to be retained
	Existing footway to be excavated and replaced by new asphalt construction:
	Surface course: 20mm AC6 Dense 100/150
	Binder course: 80mm thick AC20 dense bin 40/60
	Base: 150mm Recycled Thick Type 1
	Install asphalt (black top) on existing carriageway:
	Surface course: 40mm TSCS 10 65psv
	Install asphalt (black top) new/existing traffic island:
	Surface course: 35mm AC6 Dense 100/150
	Binder course: 80mm thick AC20 dense bin 40/60
	Base: 100mm Recycled Thick Type 1
	Install cycle track on footway:
	Surface course: 6mm AC6 Dense 100/150
	Binder course: 80mm thick AC20 dense bin 40/60
	Base: 150mm Recycled Thick Type 1
	Colour: Deep Chrome Green
	Existing paving to be removed on footway
	Install low level planting
	Existing ironworks to be adjusted
	Bench
	Install new bench
	Install cycle lane defender with 'City Post' (TMP Solutions)
	2000mm x 235mm
	Existing tree to be pruned
	Existing tree not affected
	Setting out
	Setting out dimensions

Rev	Date	Description	Drm	Chk	App
2	24/01/2024	TRAFFIC LANE AND BUS LANE WIDTHS ADJUSTED TO 3.25M	TA	DM	MA
1	18/01/2024	SECTION REMOVED / AMENDED FOLLOWING CLIENT'S COMMENTS	TA	DM	MA
0	20/11/2023	ORIGINAL ISSUE	TA	DM	MA

www.marstonholdings.co.uk/projectcentre

Client		Working in partnership <div> Barking & Dagenham</div>		
Project		LONGBRIDGE ROAD BUS PRIORITY DETAILED DESIGN		
Drawing Title		GENERAL ARRANGEMENT SECTION 4 SHEET 03 OF 03		
Drawing Status		FOR CONSTRUCTION		
Drawn	Designed	Date	Scale	Size
TA	DM	NOV 2023	1:200	A1
Drawing No.				Rev
1000009040-5-S4-0100-03				2

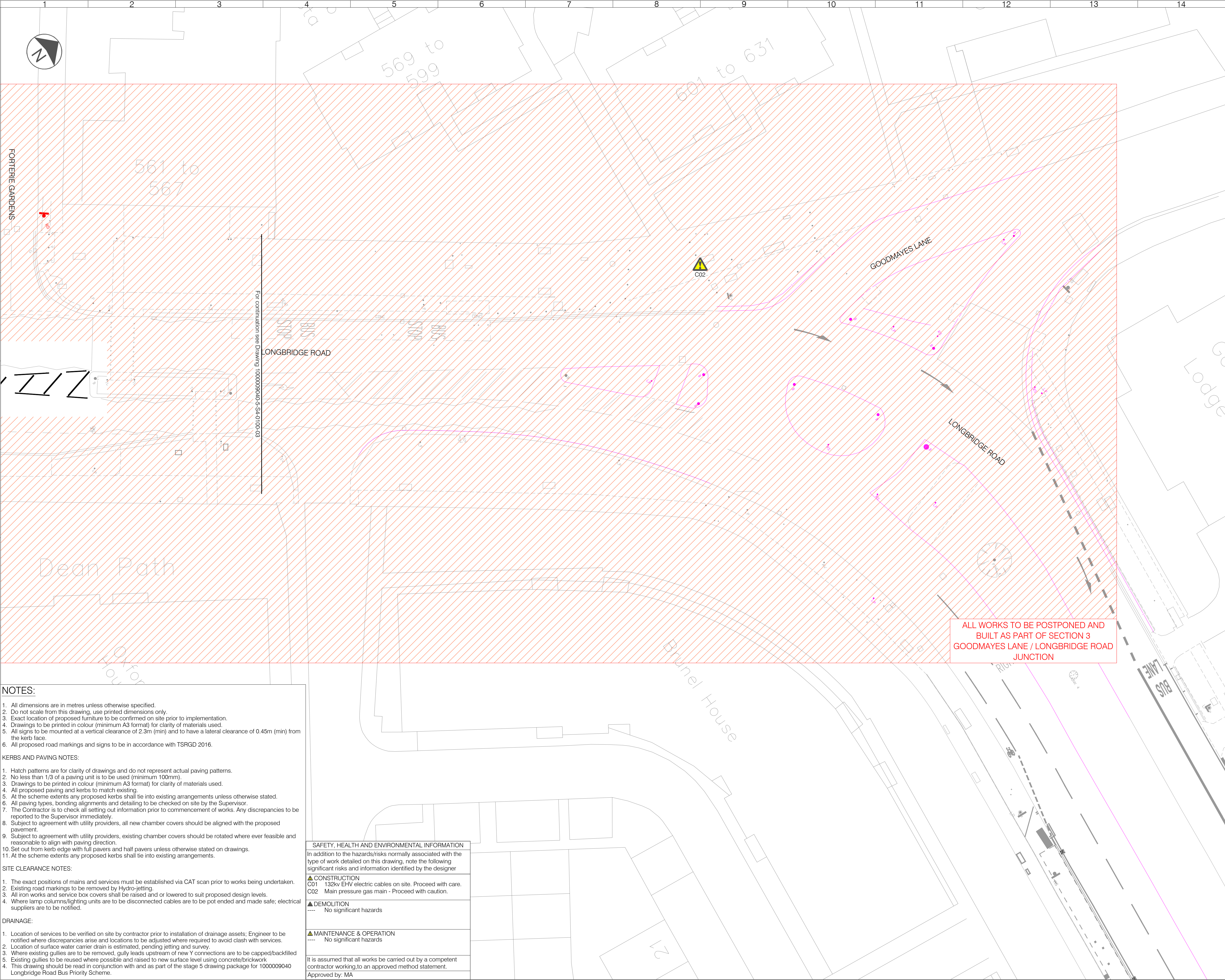

- NOTES:**
1. All dimensions are in metres unless otherwise specified.
 2. Do not scale from this drawing, use printed dimensions only.
 3. Exact location of proposed furniture to be confirmed on site prior to implementation.
 4. Drawings to be printed in colour (minimum A3 format) for clarity of materials used.
 5. All signs to be mounted at a vertical clearance of 2.3m (min) and to have a lateral clearance of 0.45m (min) from the kerb face.
 6. All proposed road markings and signs to be in accordance with TSRGD 2016.
- KERBS AND PAVING NOTES:**
1. Hatch patterns are for clarity of drawings and do not represent actual paving patterns.
 2. No less than 1/3 of a paving unit is to be used (minimum 100mm).
 3. Drawings to be printed in colour (minimum A3 format) for clarity of materials used.
 4. All proposed paving and kerbs to match existing.
 5. At the scheme extents any proposed kerbs shall tie into existing arrangements unless otherwise stated.
 6. All paving types, bonding alignments and detailing to be checked on site by the Supervisor.
 7. The Contractor is to check all setting out information prior to commencement of works. Any discrepancies to be reported to the Supervisor immediately.
 8. Subject to agreement with utility providers, all new chamber covers should be aligned with the proposed pavement.
 9. Subject to agreement with utility providers, existing chamber covers should be rotated where ever feasible and reasonable to align with paving direction.
 10. Set out from kerb edge with full pavers and half pavers unless otherwise stated on drawings.
 11. At the scheme extents any proposed kerbs shall tie into existing arrangements.
- SITE CLEARANCE NOTES:**
1. The exact positions of mains and services must be established via CAT scan prior to works being undertaken.
 2. Existing road markings to be removed by Hydro-jetting.
 3. All iron works and service box covers shall be raised and or lowered to suit proposed design levels.
 4. Where lamp columns/lighting units are to be disconnected cables are to be pot ended and made safe; electrical suppliers are to be notified.
- DRAINAGE:**
1. Location of services to be verified on site by contractor prior to installation of drainage assets; Engineer to be notified where discrepancies arise and locations to be adjusted where required to avoid clash with services.
 2. Location of surface water carrier drain is estimated, pending jetting and survey.
 3. Where existing gullies are to be removed, gully leads upstream of new Y connections are to be capped/backfilled
 5. Existing gullies to be reused where possible and raised to new surface level using concrete/brickwork
 4. This drawing should be read in conjunction with and as part of the stage 5 drawing package for 1000009040 Longbridge Road Bus Priority Scheme.

SAFETY, HEALTH AND ENVIRONMENTAL INFORMATION	
In addition to the hazards/risks normally associated with the type of work detailed on this drawing, note the following significant risks and information identified by the designer	
▲ CONSTRUCTION	
C01 132kv EHV electric cables on site. Proceed with care.	
C02 Main pressure gas main - Proceed with caution.	
▲ DEMOLITION	
---- No significant hazards	
▲ MAINTENANCE & OPERATION	
---- No significant hazards	
It is assumed that all works be carried out by a competent contractor working to an approved method statement.	
Approved by: MA	

LEGEND	
	Install yellow road marking
	Thermoplastic screed with applied glass beads
	Install white road marking
	Thermoplastic screed with applied glass beads
	Install upstand kerb (80mm to 125mm upstand)
	Precast Concrete, silver grey
	Install upstand kerb by bus stops (125mm upstand)
	Precast Concrete, silver grey
	Install dropped kerb (0mm upstand)
	Precast Concrete, silver grey
	Install dropper/transition Kerb
	Precast Concrete, silver grey
	Install flushed kerb (0mm upstand)
	Precast Concrete, silver grey
	Install edging kerb
	Change of level
	Direction of surface water flow
	Install new posts
	Galvanised steel, straight sign posts
	Install new signs
	Install illuminated bollard on traffic islands
	Install wooden bollard
	Install new/relocated lamp column
	Existing post to be removed
	Existing sign to be removed
	Install buff tactile paving
	400x400x65mm
	Existing gully to be retained
	Existing footway to be excavated and replaced by new asphalt construction:
	Surface course: 20mm AC6 Dense 100/150
	Binder course: 80mm thick AC20 dense bin 40/60
	Base: 150mm Recycled Thick Type 1
	Install asphalt (black top) on existing carriageway:
	Surface course: 40mm TSCS 10 65psv
	Install asphalt (black top) new/existing traffic island:
	Surface course: 35mm AC6 Dense 100/150
	Binder course: 80mm thick AC20 dense bin 40/60
	Base: 150mm Recycled Thick Type 1
	Colour: Deep Chrome Green
	Install cycle track on footway:
	Surface course: 6mm AC6 Dense 100/150
	Binder course: 80mm thick AC20 dense bin 40/60
	Base: 150mm Recycled Thick Type 1
	Colour: Deep Chrome Green
	Existing paving to be removed on footway
	Install low level planting
	Existing ironworks to be adjusted
	Install new bench
	Install cycle lane defender with 'City Post' (TMP Solutions)
	2000mm x 235mm
	Existing tree to be pruned
	Existing tree not affected
	Setting out
	Setting out dimensions

Rev	Date	Description	Drm	Chk	App
1	18/01/2024	SECTION REMOVED / AMENDED FOLLOWING CLIENT'S COMMENTS	TA	DM	
0	20/11/2023	ORIGINAL ISSUE	TA	DM	MA

www.marstonholdings.co.uk/projectcentre

Client	
<div>Working in partnership</div> <div> </div>	
Project	
LONGBRIDGE ROAD BUS PRIORITY DETAILED DESIGN	
Drawing Title	
GENERAL ARRANGEMENT SECTION 4 SHEET - OF 03	
Drawing Status	
FOR CONSTRUCTION	
Drawn	Designed
TA	DM
Date	Scale
NOV 2023	1:200
Size	Size
A1	A1
Drawing No.	Rev
1000009040-5-S4-0100--	1